

- NOTES:**
1. Do not scale from the drawing, all dimensions are nominal and must be checked on site.
 2. Take heed in conjunction with architect's and engineering drawings, specifications and schedules.
 3. Any dimension notes should be brought to the attention of the architect, if in doubt ask.
 4. For dimensions set out and erection details refer to architect's drawings.
 5. These drawings are copyright of Halden MEP Ltd, please do not be modified or reproduced without Halden MEP Ltd's permission.

PARTICULAR NOTES:

- Floodlight luminaires to be mounted on 12m mid height columns as shown for maintenance purposes.
- E22 Type floodlights to be Thorn Clampton, high power LED Type 11540JIM, 350W LED, 600 lumens, 4000K colour temperature.
- Pitch lighting to be fed via new local feeder pillar, served via new classroom block's distribution system.
- Pitch floodlighting control strategy to be confirmed as part of the following design stages.

BASED ON ARCHITECT'S DRAWING:

4731464-00-06A-1016-S1

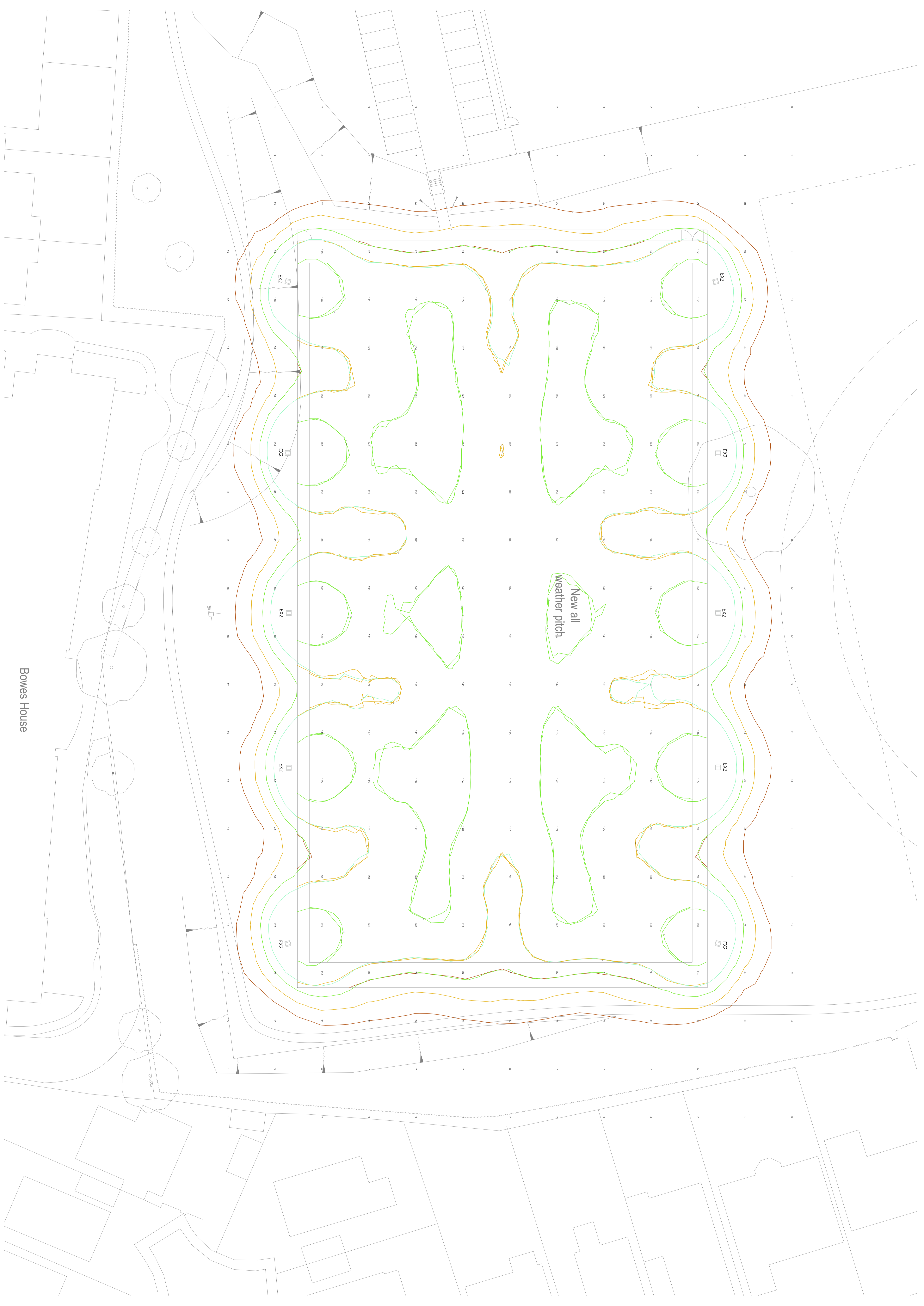

Bowers House

New all weather pitch

Author: M. J. HAWDEN	Date: 01/07/24
Rev: 2/02/2024	Drawn: M. J. HAWDEN
Project: HAILSHAM COMMUNITY COLLEGE	
Title: NEW ALL WEATHER PITCH EXTERNAL LIGHTING LAYOUT	
Scale: 1:300	
Status: PRELIMINARY	
Company: HAWDEN ENGINEERING MEP SOLUTIONS	
Halden MEP Solutions Limited, 100, The Quadrant, Hailsham, East Sussex, BN27 1YU Telephone: 01323 560077 Fax: 01323 560078 Email: info@haldenmep.com	
Drawing No: 20014-HAW-00-GF-DR-E-5102	Rev: A 501